



# ALGONQUIN

Corporate Center

THE FUTURE IS HERE  
NORTH KANE COUNTY'S PREMIER  
NEW DEVELOPMENT

Longmeadow Pkwy and Randall Rd  
Algonquin, IL  
60102



BUILDING 1:  
**116,236**  
SQUARE FEET

1.6M SF OF NEW CONSTRUCTION



PLAY VIDEO



VISIT WEBSITE

## MIKE SEDJO

Senior Vice President  
+1 847 269 8883  
mike.sedjo@cbre.com

## JOHN HAMILTON

First Vice President  
+1 847 706 4909  
john.hamilton@cbre.com

## BEN DICKEY

Vice President  
+1 630 573 1297  
ben.dickey@cbre.com

**CBRE**





# LOCATION



## SITE ADVANTAGES

CLASS A INDUSTRIAL FACILITIES WITH  
GENEROUS TI PACKAGES



ABUNDANT HIGHLY  
SKILLED LABOR POOL



GREENFIELD DEVELOPMENT INCLUDING  
SPEC BUILDINGS AND AMPLE OPPORTUNITY  
FOR BUILD TO SUIT SUITES



147 ACRE  
PARK





# MASTER PARK PLAN



## UNBEATABLE LOCATION

Algonquin offers a prime location for employees to work and live, with highly rated schools and diverse amenities close at hand. The site has easy access to I-90, and O'Hare airport is just 35 minutes away.



## HIGHLY EXPERIENCED

Established in 2012, NorthPoint Development is a privately held real estate operating company specializing in developing, acquiring, leasing, and managing Class A industrial, data centers, and multi-family properties.

Through their in-house suite of services, NorthPoint can provide end-to-end expertise, leading to expedited solutions. Serving industry-leading clients such as Chewy, Home Depot, GE, Amazon, Tesla, Ryder, ABF and PepsiCo.





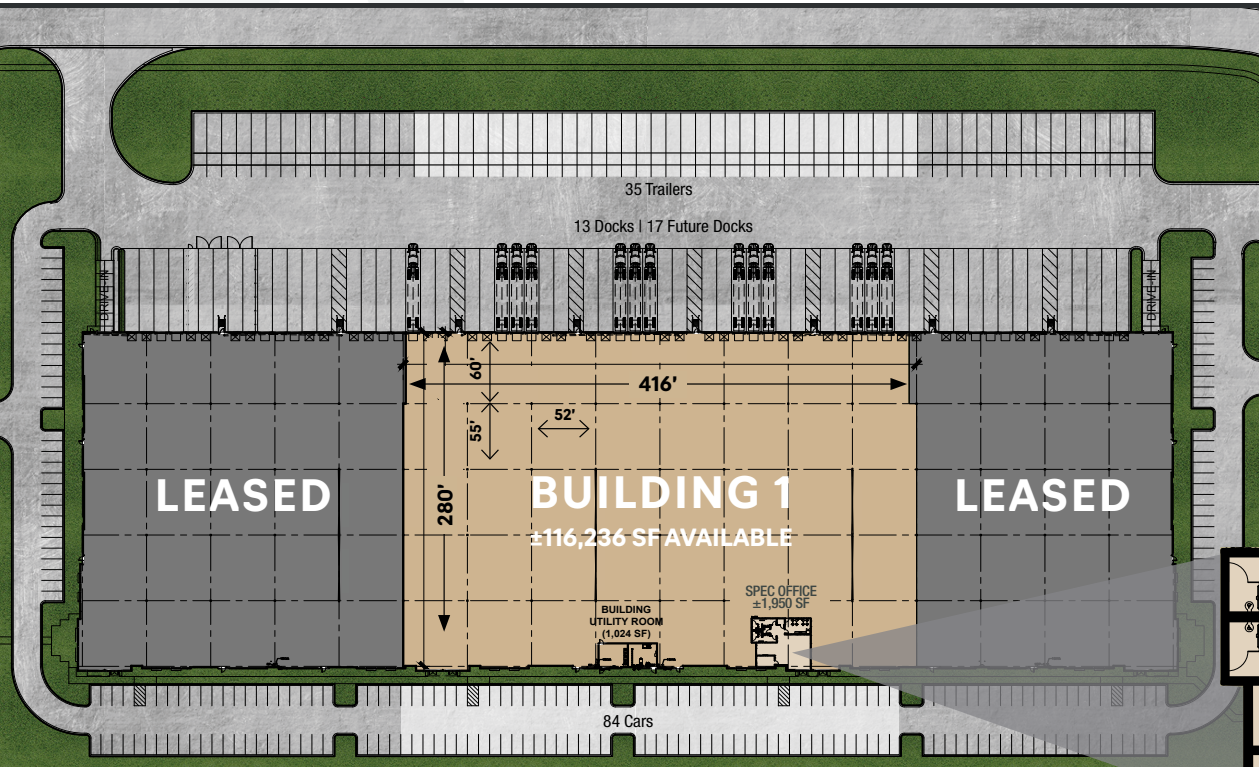

## UNIQUE TO THE MARKET

Algonquin Corporate Center offers the earliest spec opportunity in Kane County, with buildings 1 and 2 delivered and ready for TI customization.

# BUILDING 1 SPECIFICATIONS



-  ± 1,950 SF SPEC OFFICE
-  13 DOCKS
-  17 FUTURE
-  35 TRAILERS
-  84 CARS

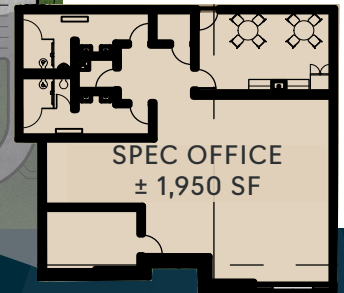

<b>AVAILABLE SF AREA</b>	±116,236	<b>FLOOR SLAB</b>	7" non-reinforced concrete, 4,000 PSI
<b>SPEC OFFICE</b>	±1,950 SF	<b>LIGHTING</b>	LED with motion sensors, 30 FC average; measured at 30" AFF
<b>CAR PARKING</b>	84	<b>CONSTRUCTION</b>	Insulated Precast Panel
<b>TRAILER PARKING</b>	35	<b>ELECTRICAL SERVICE</b>	2,400 Amp
<b>COLUMN SPACING</b>	52' x 55' with 60' speedbays	<b>SPRINKLER SYSTEM</b>	ESFR
<b>CLEAR HEIGHT</b>	36'	<b>HVAC</b>	50°F at -0°F, 0.25 ACH
<b>DOCK DOORS</b>	13	<b>LEED CERTIFIED</b>	Yes
<b>FUTURE DOCK DOORS</b>	17	<b>SOLAR COMPATIBILITY</b>	Yes
<b>TRUCK COURT</b>	130' (185' with trailer parking)		

©2024 CBRE, Inc. All rights reserved. This information has been obtained from sources believed reliable, but has not been verified for accuracy or completeness. You should conduct a careful, independent investigation of the property and verify all information. Any reliance on this information is solely at your own risk. CBRE and the CBRE logo are service marks of CBRE, Inc. All other marks displayed on this document are the property of their respective owners, and the use of such logos does not imply any affiliation with or endorsement of CBRE. Photos herein are the property of their respective owners. Use of these images without the express written consent of the owner is prohibited. PMStudio\_September2024